

wiper A11-SB

seal spec

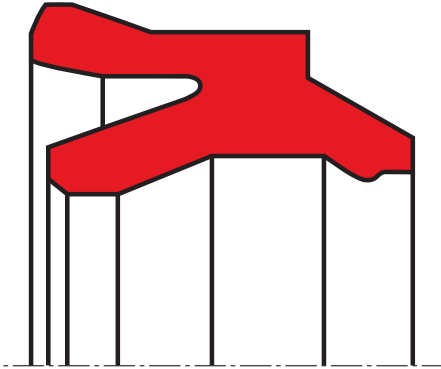

description

combination wiper seal without metal reinforcement with special pneumatic sealing edge.

application



not bolded symbols; please consult our technical for application limitations

category of profile

machined or molded/standard/trade product.

double acting

area of application: pneumatic

small cylinders.

medium

prepared, dried and de-oiled compressed air (after greasing for fitting).

advantages

- combination seal with minimal space requirements, which seals inwards and wiper outwards.
- the special pneumatic sealing edge gives very good tightness with low friction and maintains an effective lubricating film.
- optimal material for high loads.

operating parameters & material

material	temperature	max. surface speed	max. pressure ¹
s-mart NBR (90 shore A)	-20 °C ... +100 °C	1 m/s	10 bar (1 Mpa)

the stated operation conditions represent general indications. it is recommended not to use all maximum values simultaneously.
surface speed limits apply only to the presence of adequate lubrication film.

¹ pressure ratings are dependent on the size of the extrusion gap.

surface quality

surface roughness	Rtmax (µm)	Rp/Rz (µm)
rod	≤ 4	<0,5
groove base	≤ 10	<0,5

**tolerance recommendation**

seal housing tolerances		cs	R [mm]
d	f9	≤ 5	max. 0,3
D	H10	>5.....≤ 7,5	max. 0,4
		>7,5.....≤ 10	max. 0,6
		> 10	max. 0,8

fitting & installation

Careful fitting is a prerequisite for the correct function of the seal.

A11-SB for small cylinders can be snapped by hand into the housing grooves provided, with the piston rod removed.

seal & housing recommendations

please note that we are able to produce those profiles to your specific need or any non standard housing. for detail measurements, please see seal-mart catalog...

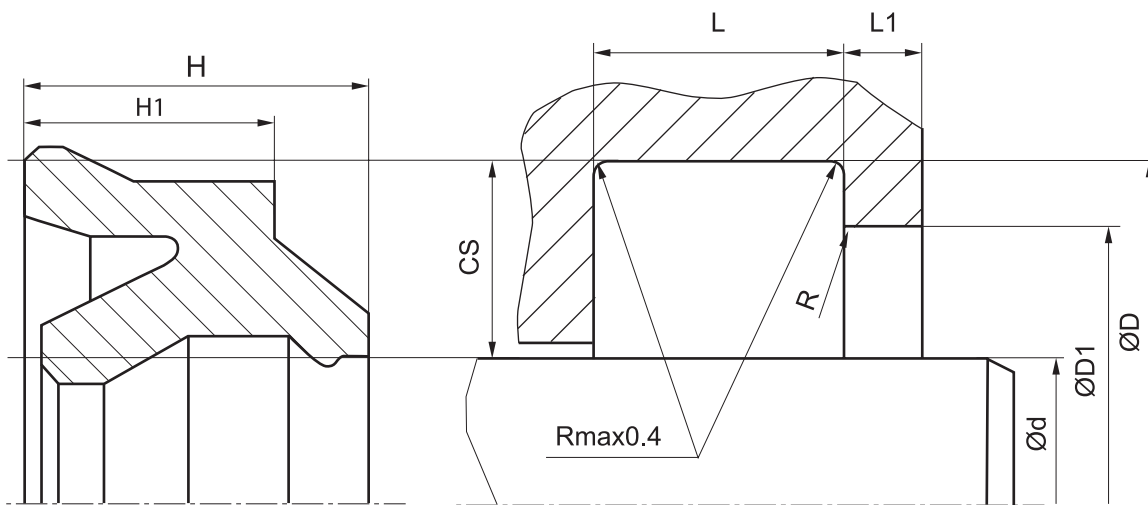

don't hesitate to contact our technical department for further information or for special requirements (temperature, speed etc.), so that suitable materials and/or designs can be recommended.